

PILASTRATA 37

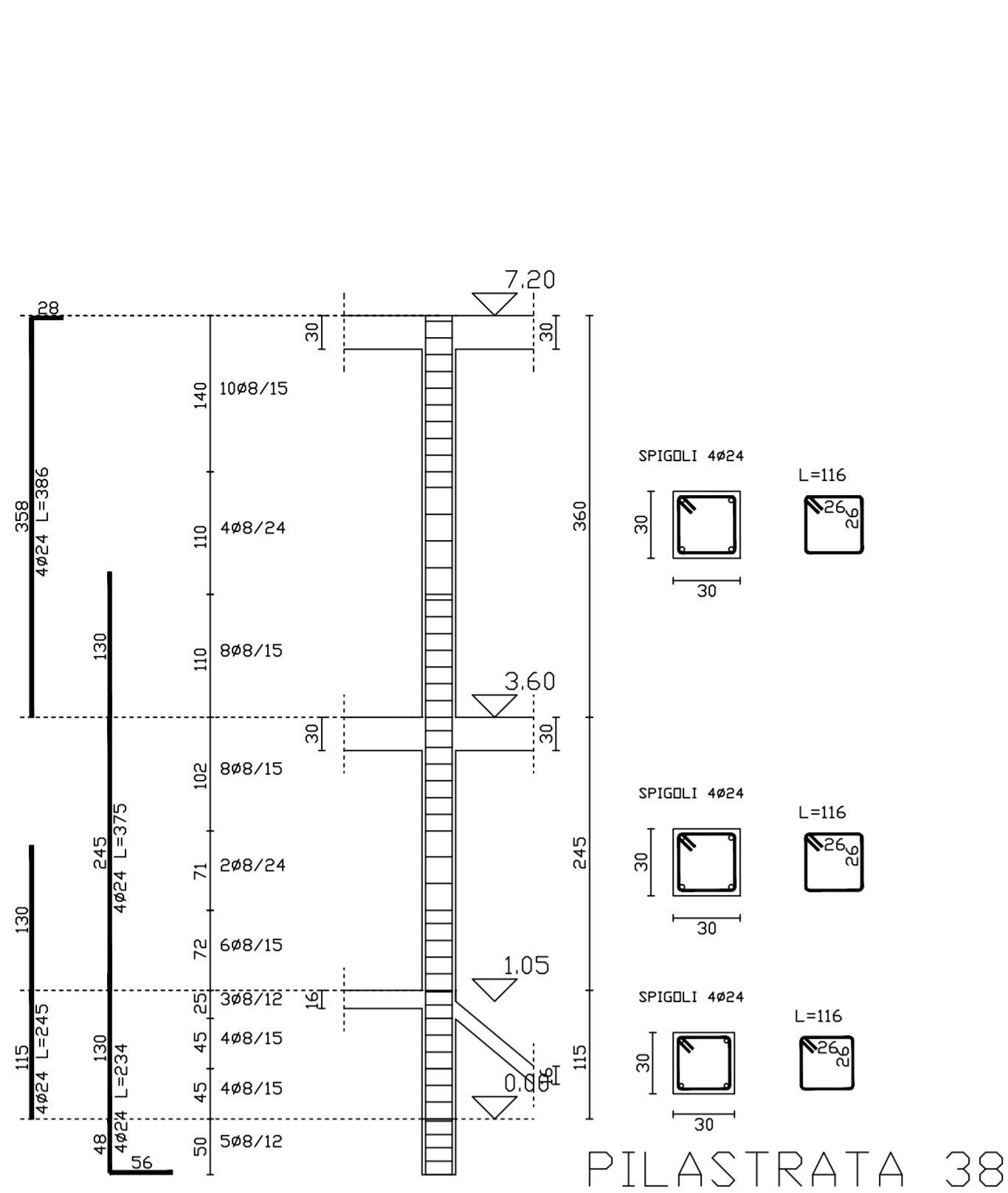

PILASTRATA 38

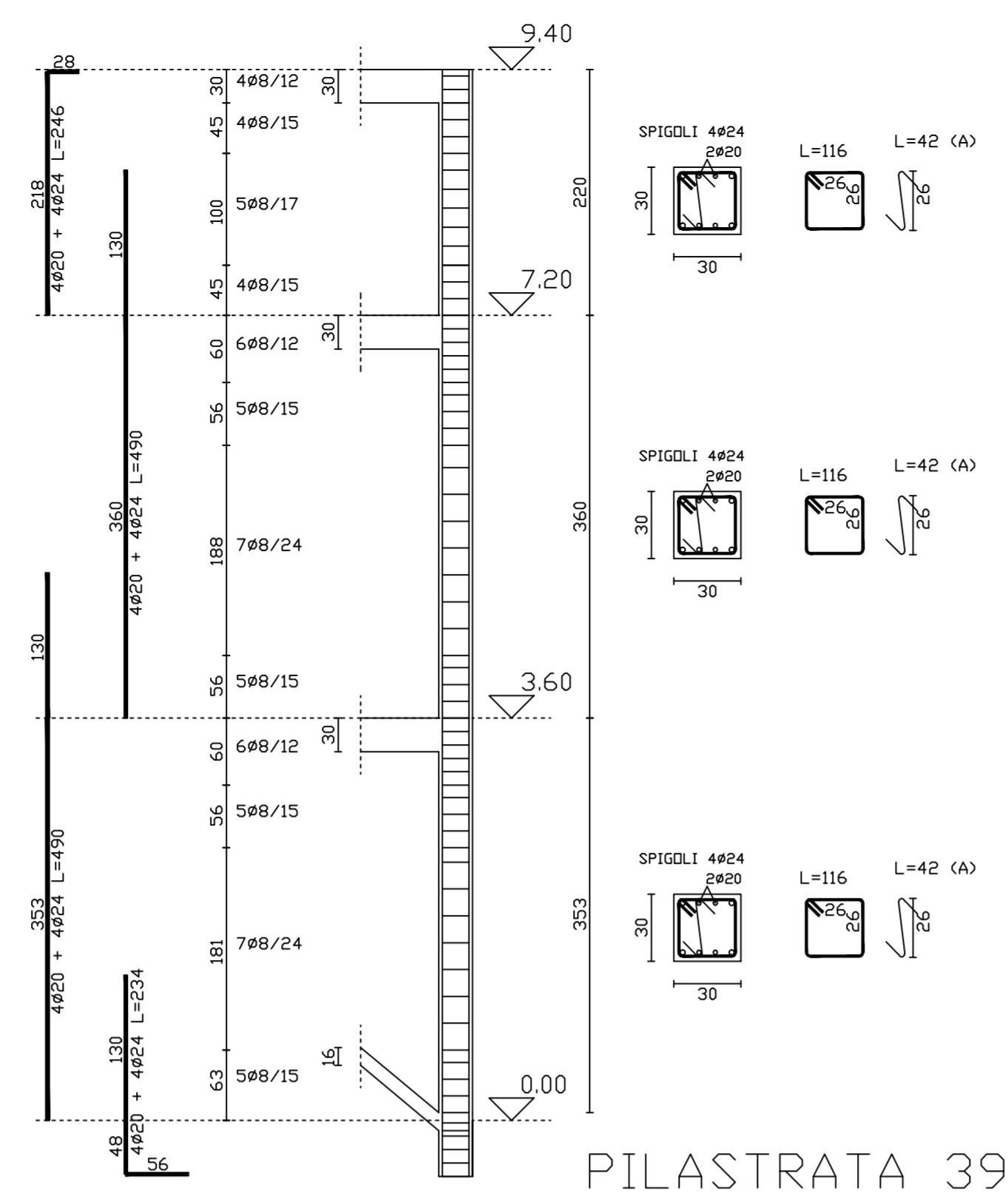

PILASTRATA 39

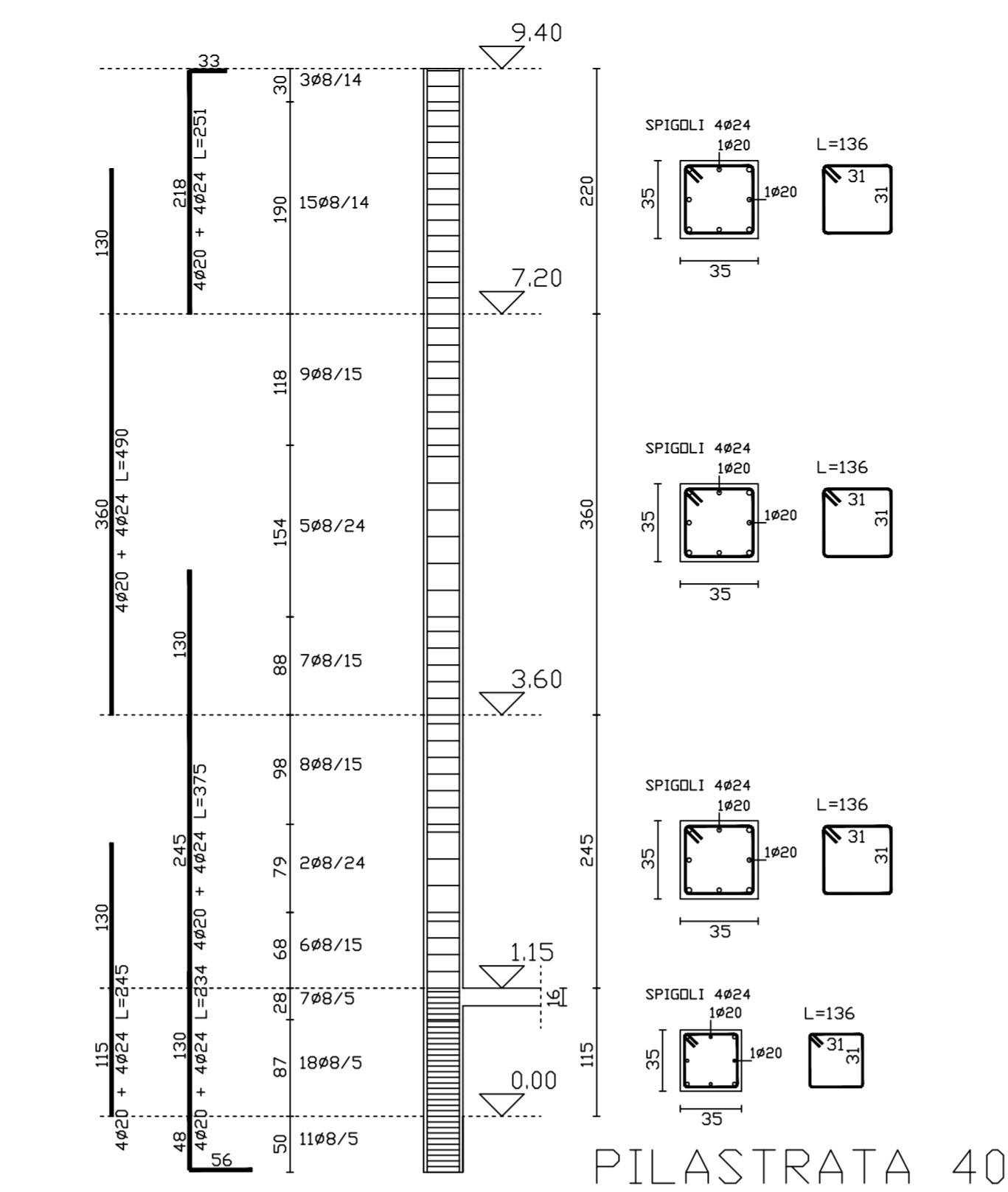

PILASTRATA 40

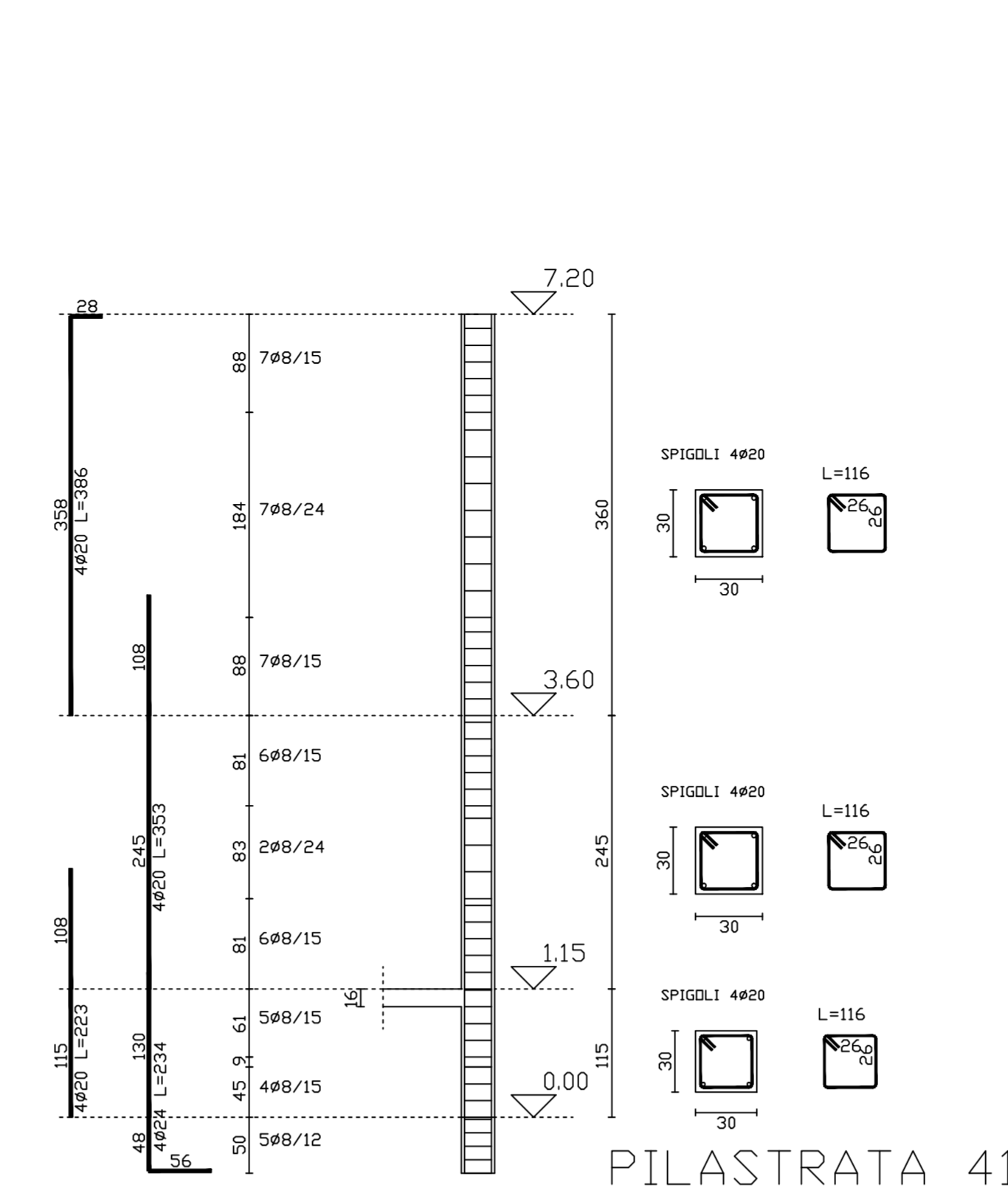

PILASTRATA 41

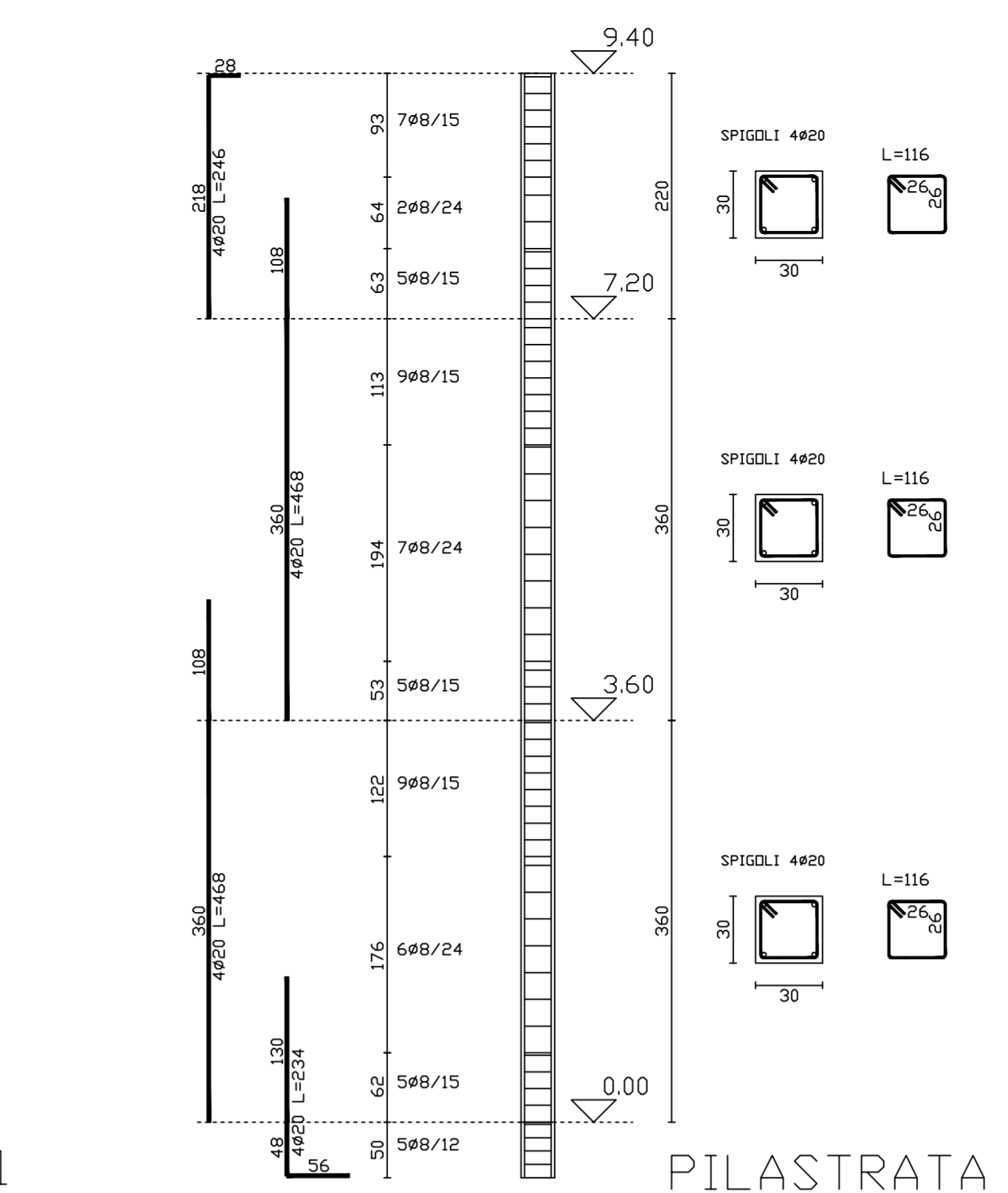

PILASTRATA 42

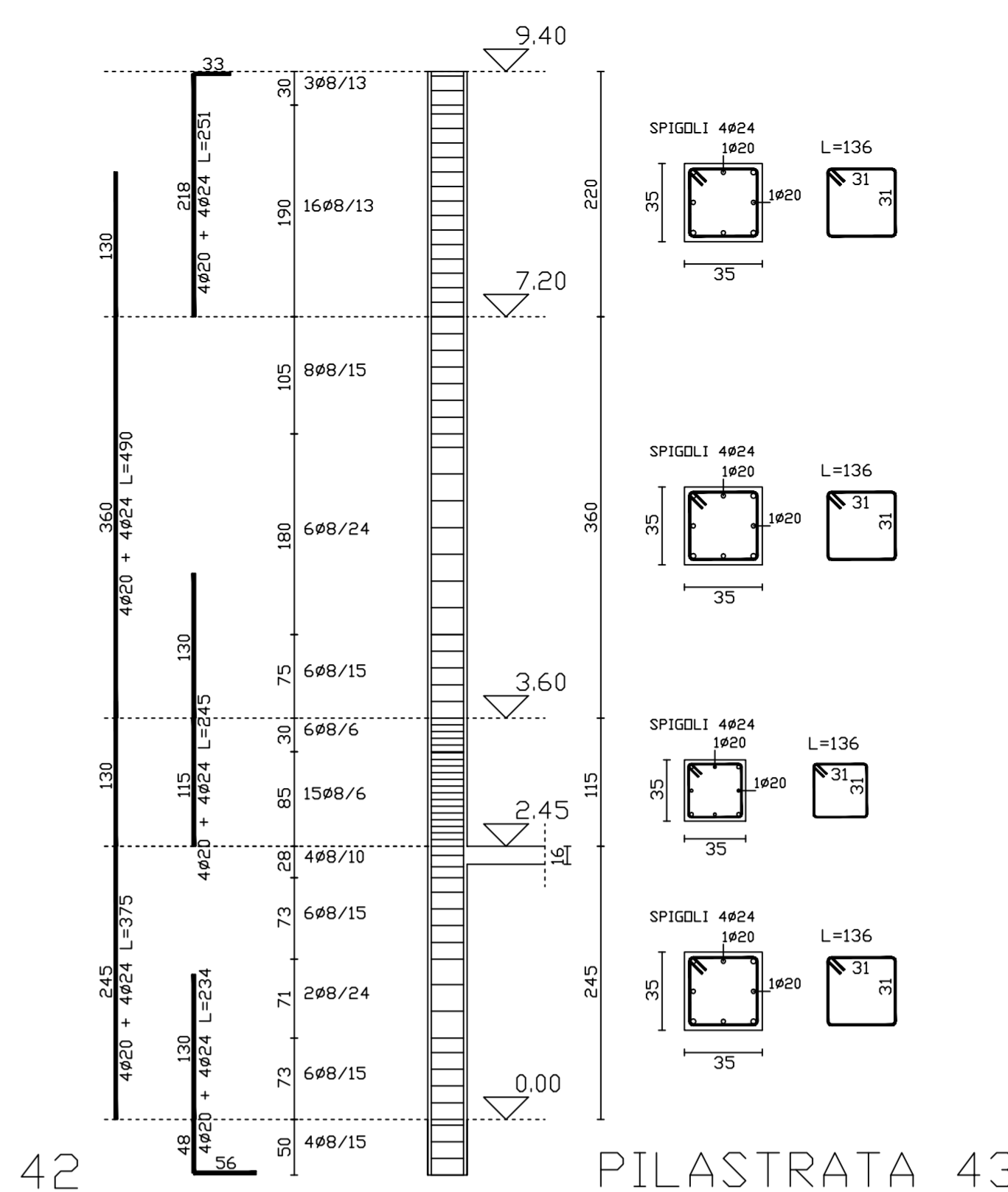

PILASTRATA 43

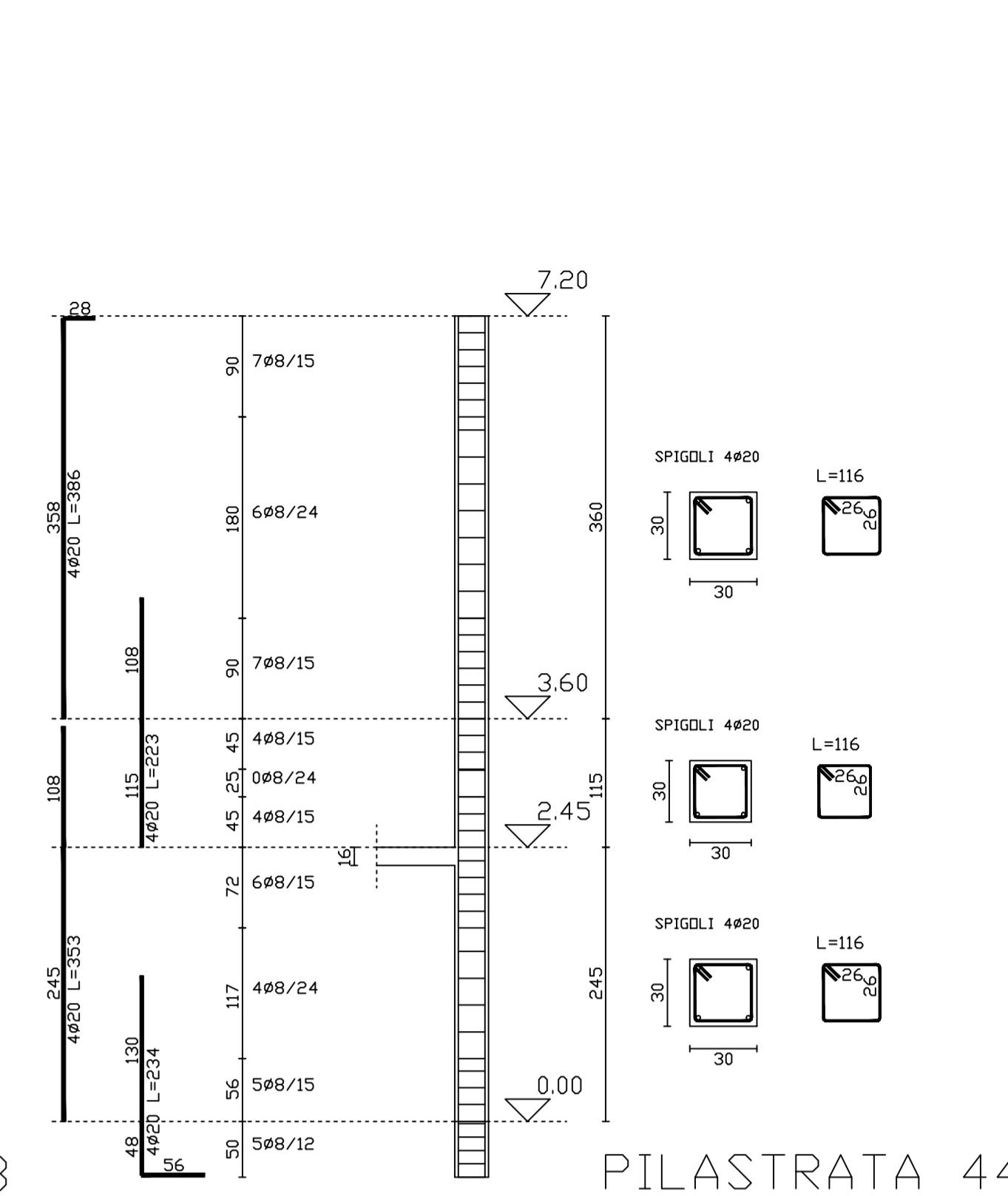

PILASTRATA 44

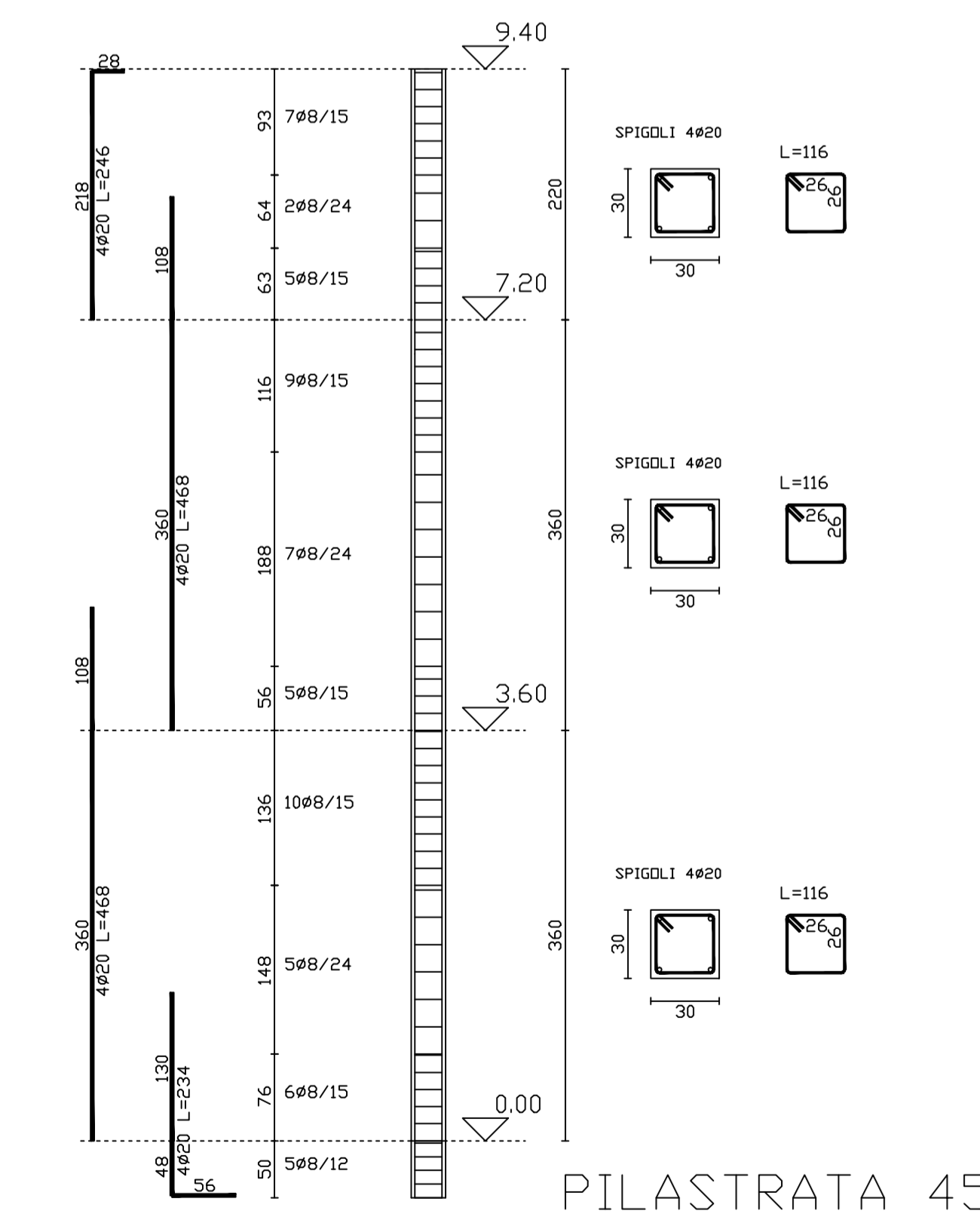

PILASTRATA 45

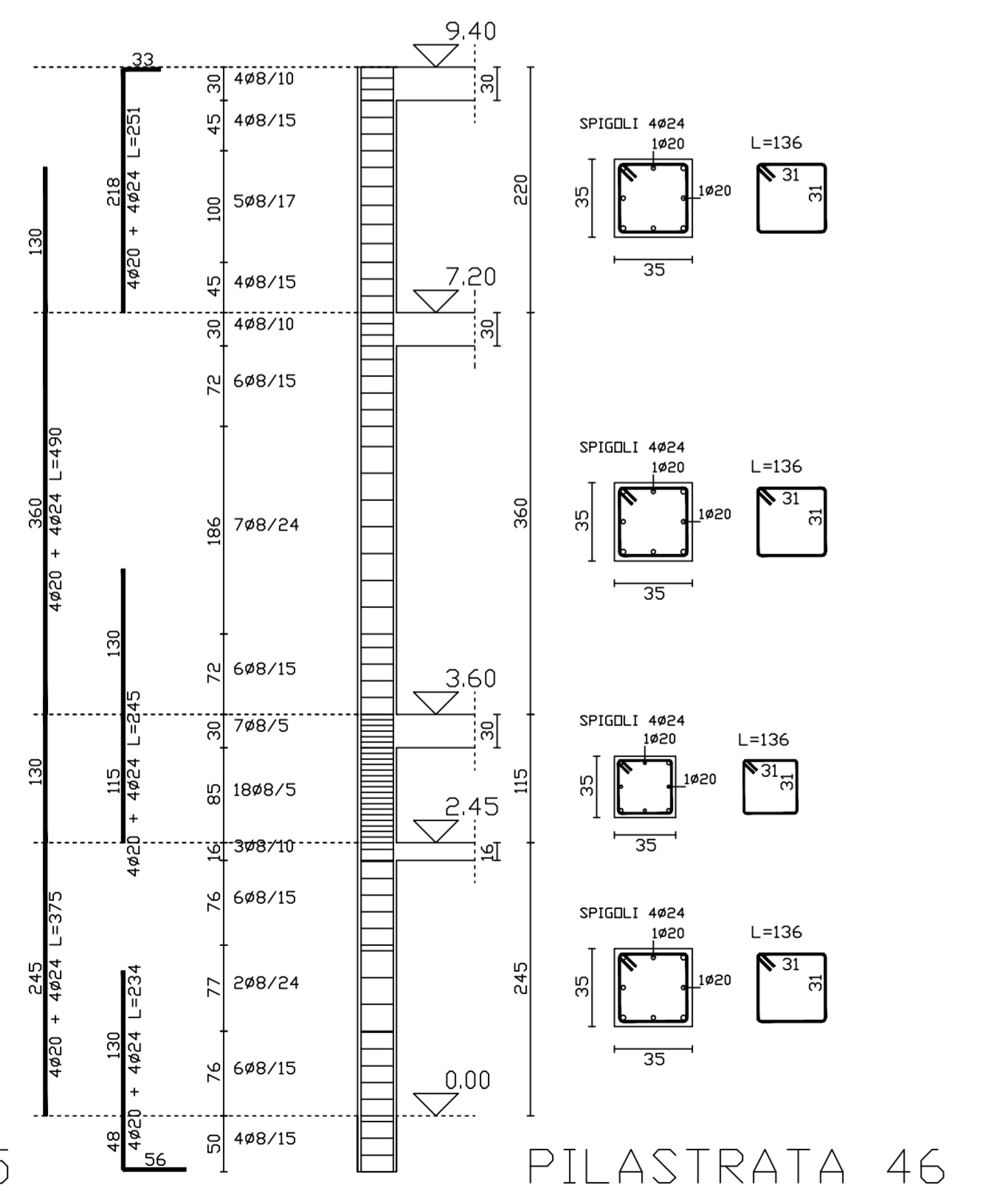

PILASTRATA 46

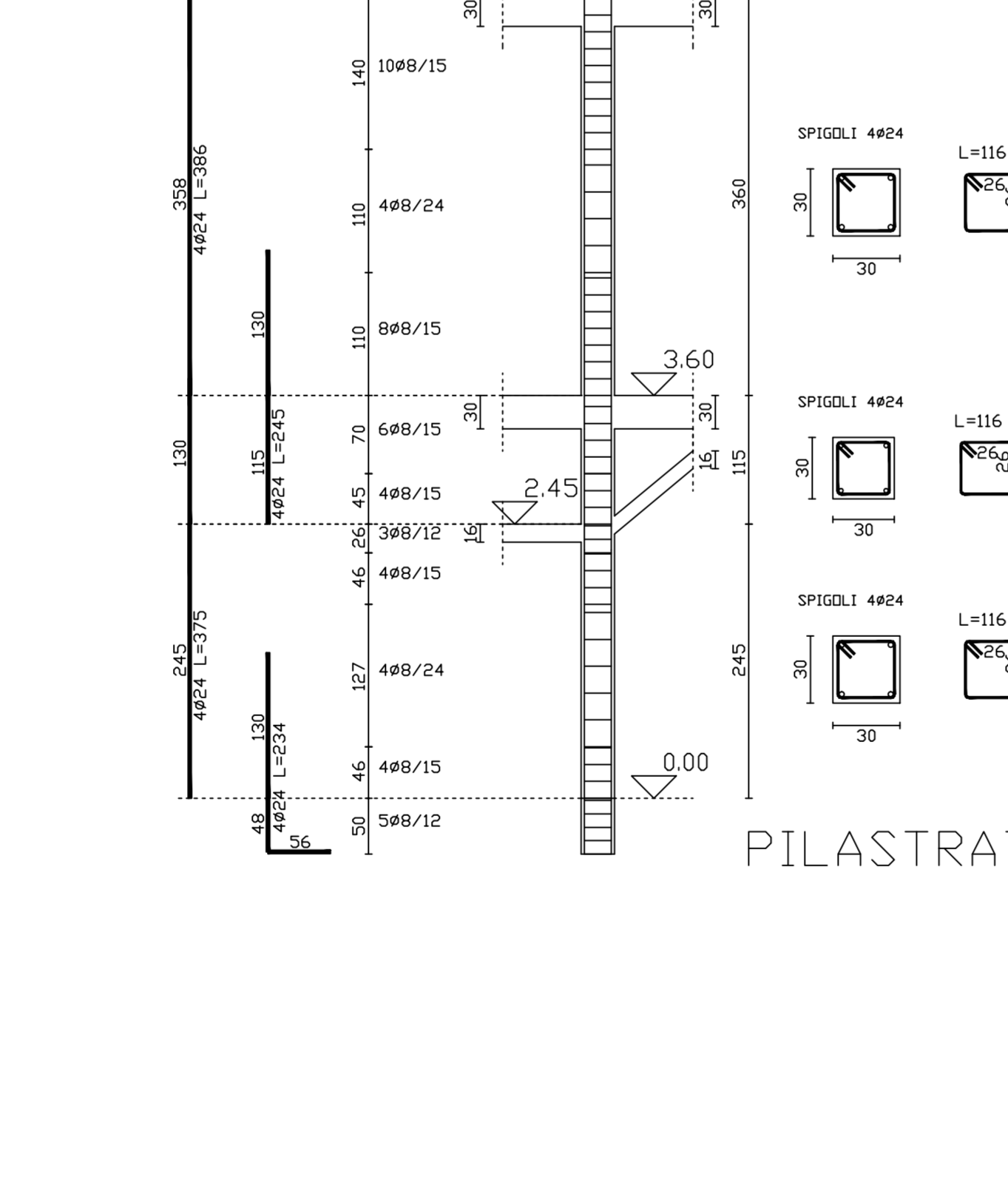

PILASTRATA 47

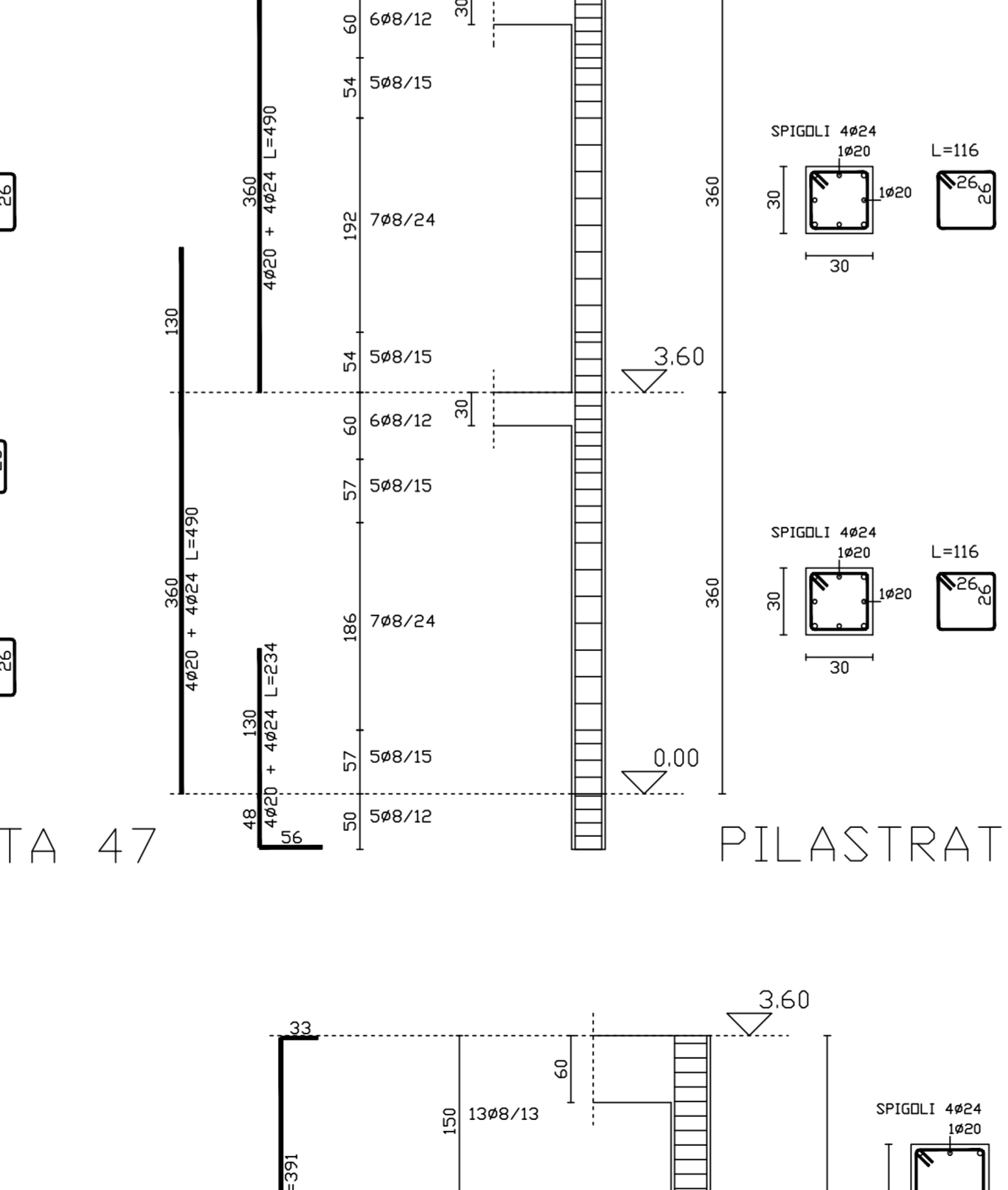

PILASTRATA 48

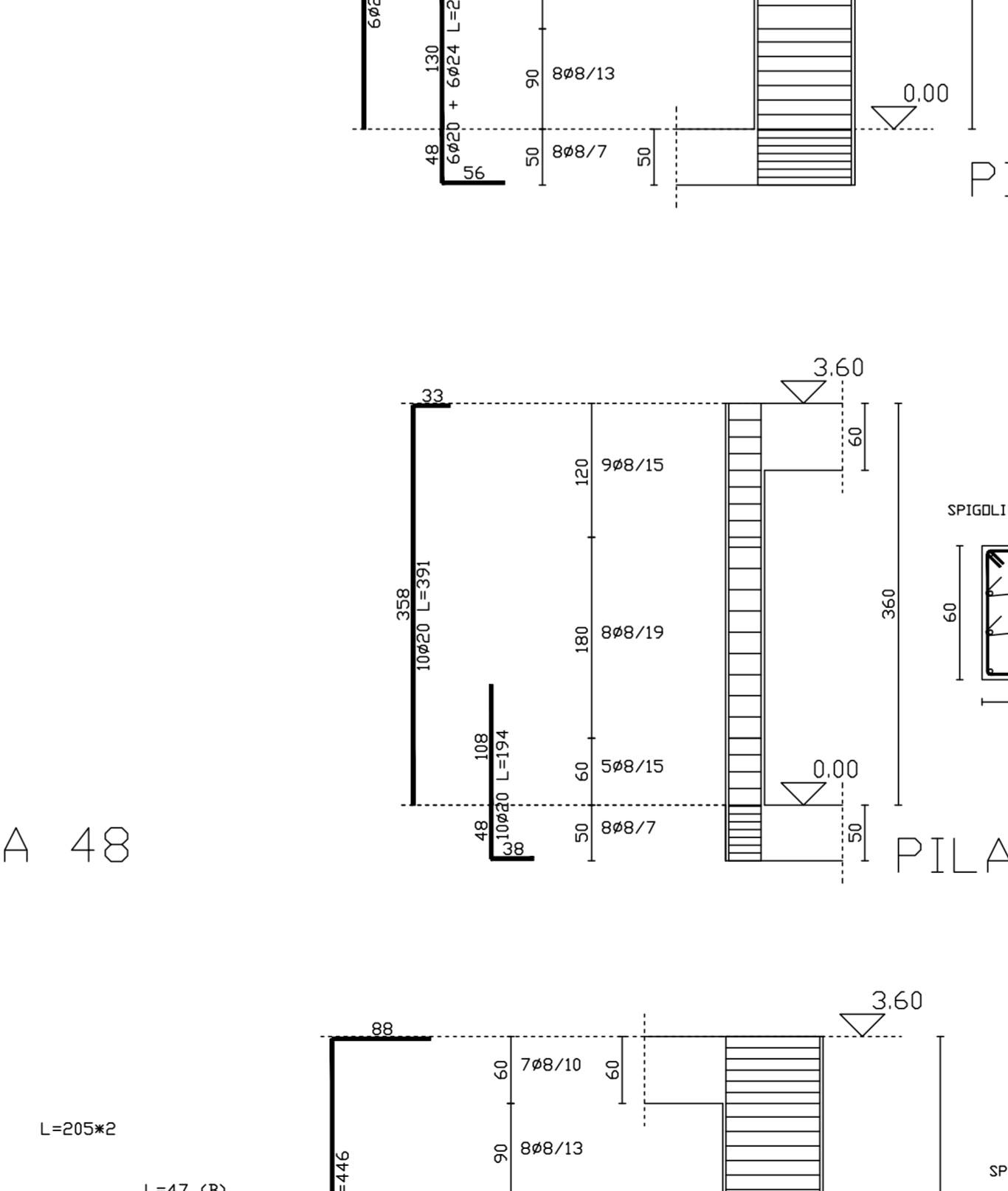

PILASTRATA 49

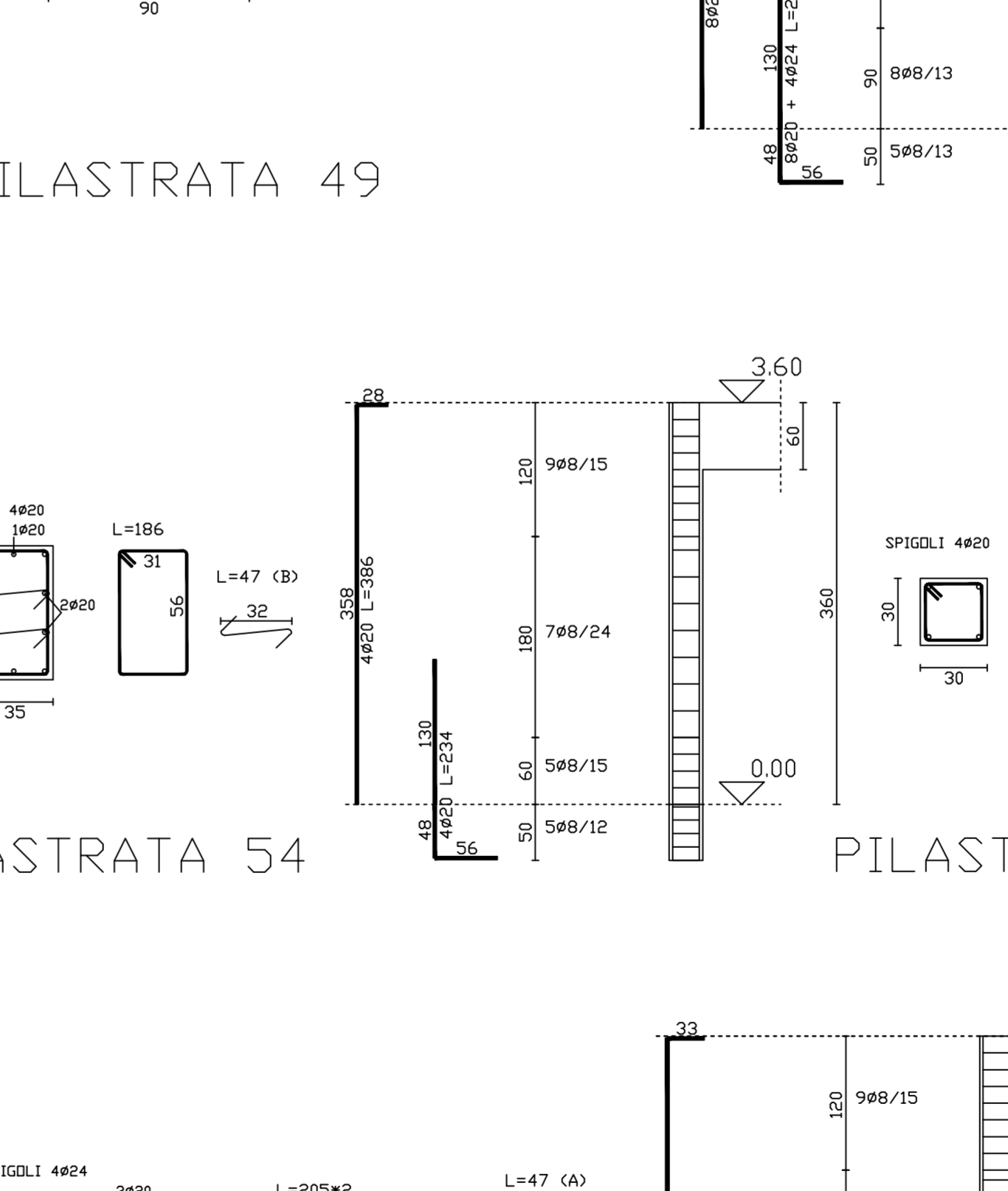

PILASTRATA 50

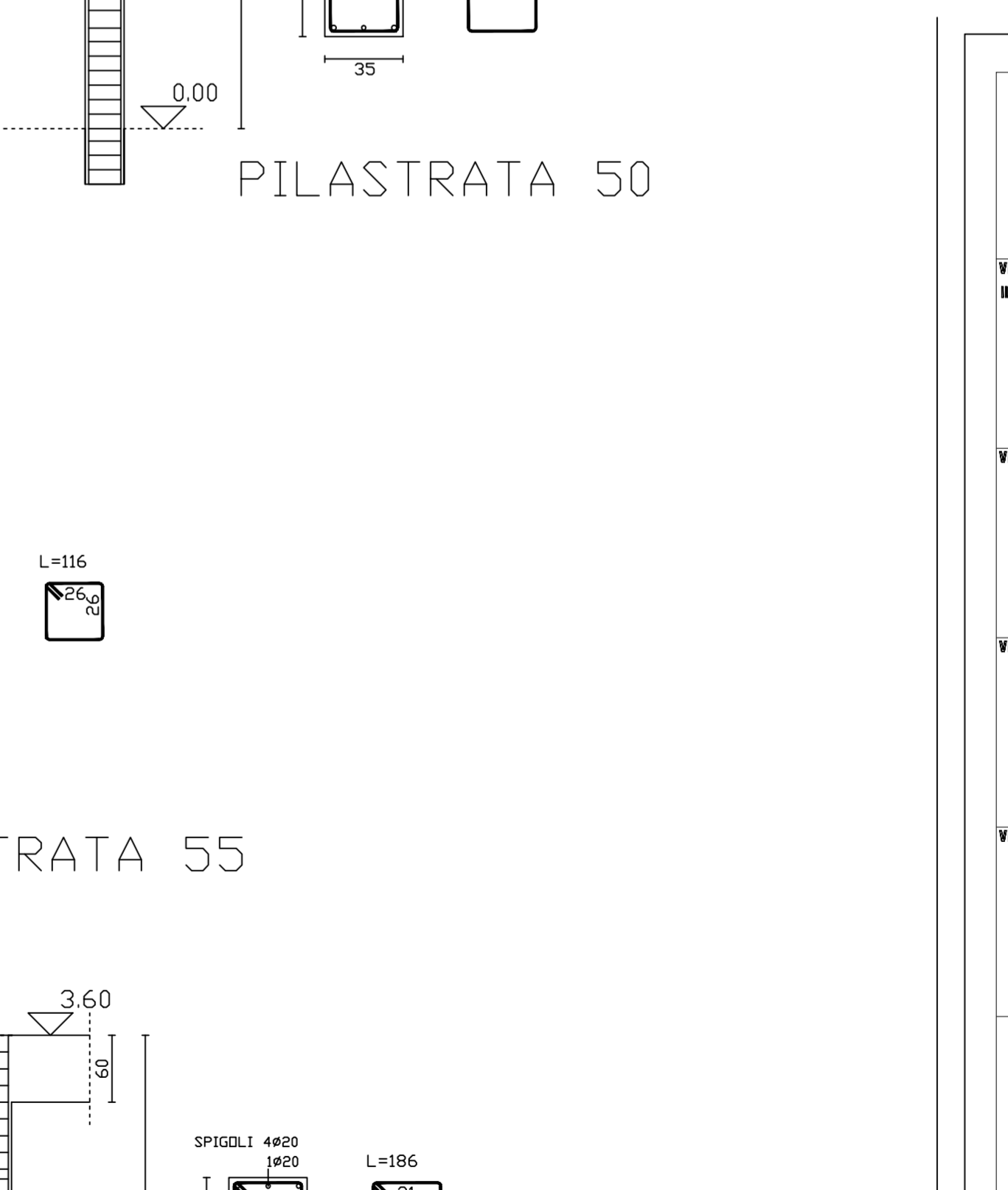

PILASTRATA 51

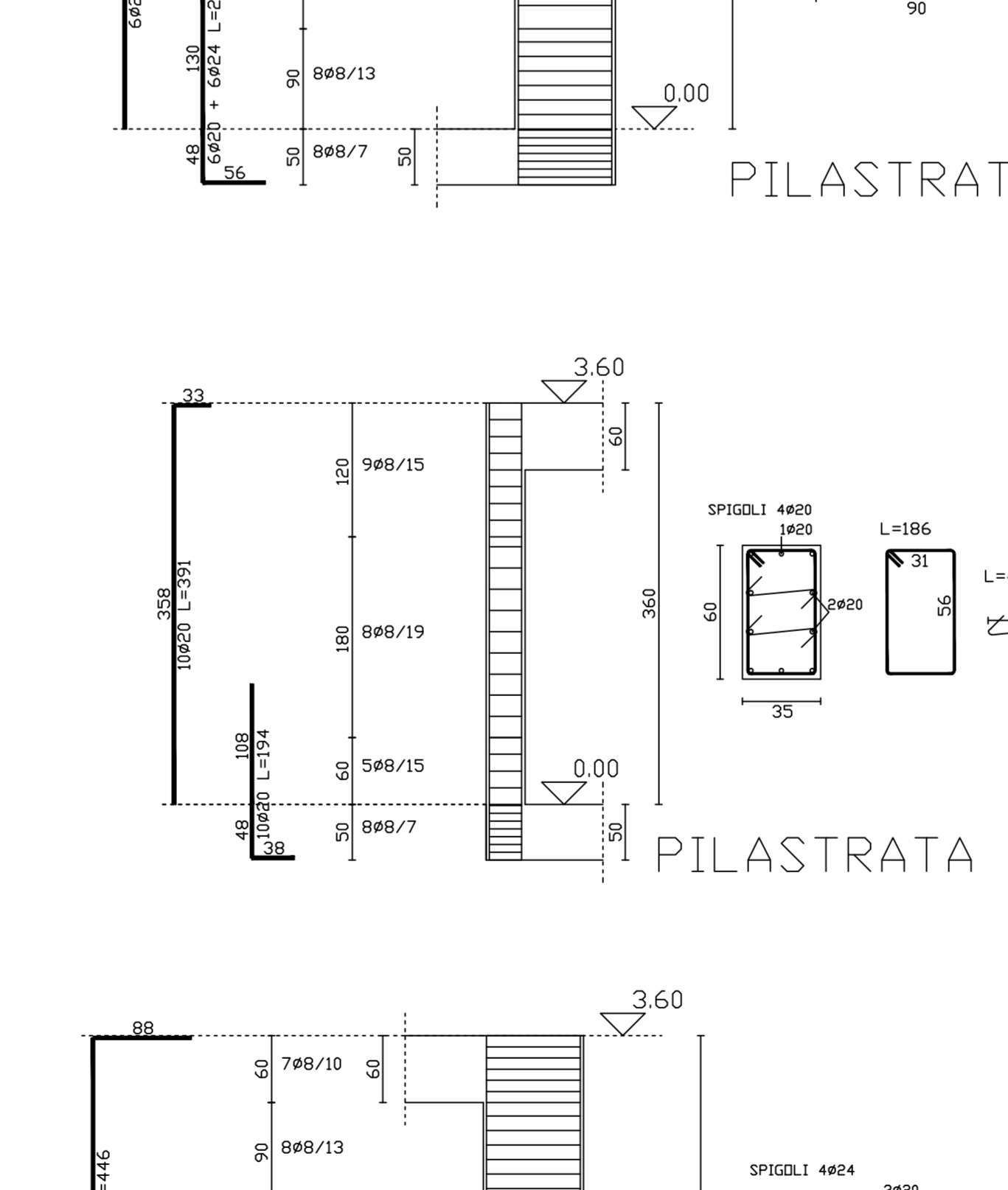

PILASTRATA 52

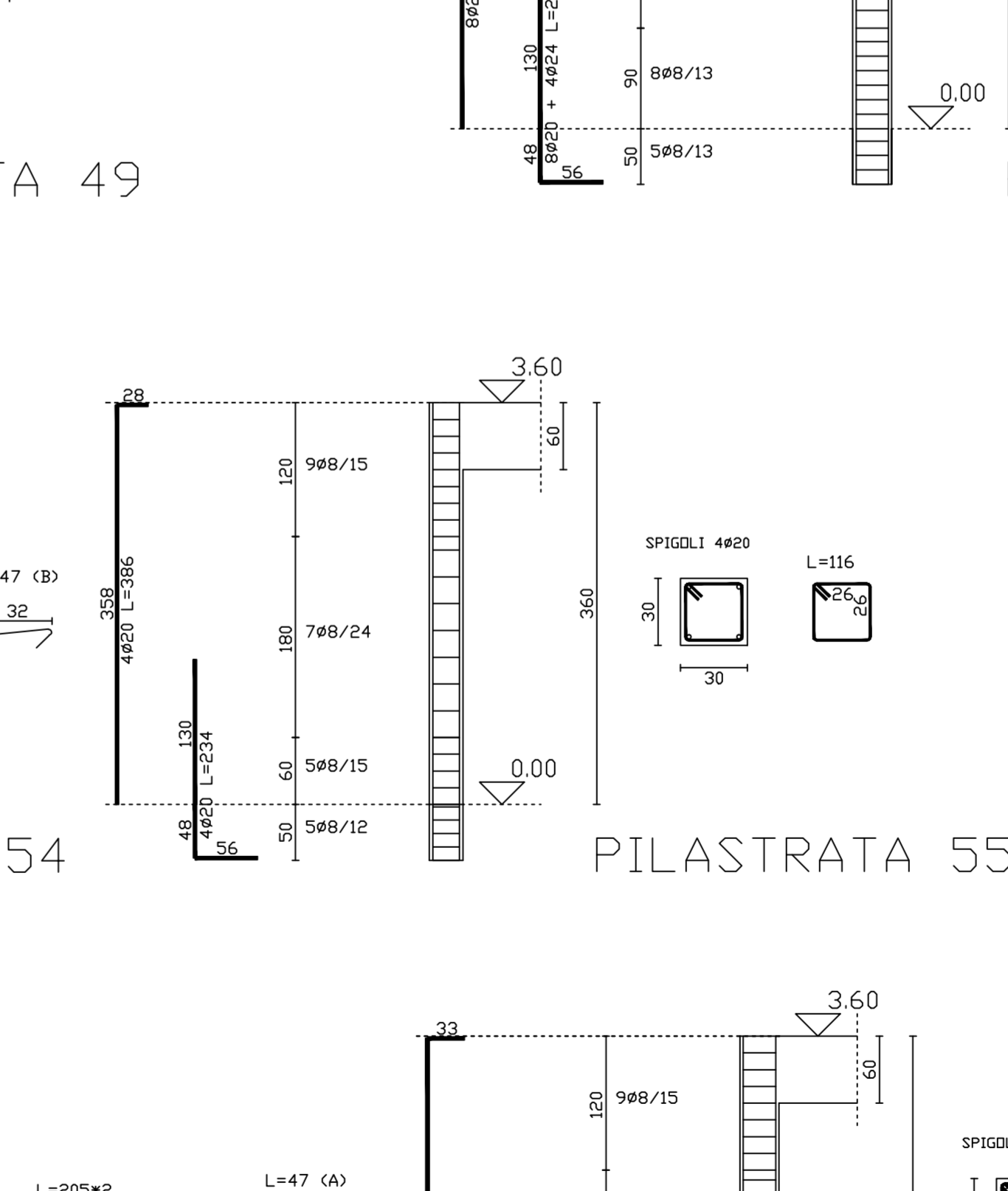

PILASTRATA 53

<b>REGIONE SICILIANA</b> UFFICIO REGIONALE DI PROTEZIONE CIVILE	
<p>VITO IL RESPONSABILE DEL PROCEDIMENTO</p> <p>VITO</p> <p>VITO</p> <p>VITO</p>	
<p><i>Raffaele Vitello</i></p>	
<p><b>PROGETTO PER LA NUOVA SEDE DI DISTACAMENTO VV.F. DI AUGUSTA (SR) 1° STRALCIO</b></p> <p>ELABORATI STRUTTURALI CORPO CENTRALE - PILASTRATE TAV.3</p>	
<p>LABORATO: <b>C.3.8.5</b> <b>RNU 2</b></p> <p>PROGETTO: <b>ESECUTIVO</b></p>	<p>OGGETTO: <b>ELABORATI STRUTTURALI CORPO CENTRALE - PILASTRATE TAV.3</b></p> <p>PROGETTISTI: <b>ING. ANNA PARRINO</b> <b>ARCH. RAFFAELE VITTELLO</b></p> <p>COORD. SICUREZZA: <b>ING. MAURIZIO SCHILLACI</b> <b>STUDIO GEOLOGICO GEOL. CIWZIA GURRERI</b></p>
<p>COICE</p> <p>SCALA</p>	<p>LIBRO DI FINANZIAMENTO LEGG. 31/12/1991 n. 430 (ART. 15, LETT. A)</p> <p>DATA</p> <p>1/50</p> <p>LUGLIO 2013</p>